

# Fixed castor CSF 125 EB

Transport Series CD - Wheel E

 -20 °C - +70 °C

++

swivels easily

++

wear resistant

++

shock proof

+++

floor protective

++

weather proof

Wheel



Tread: Elastic solid rubber tyre, black, 73±5 Shore A, vulcanised on wheel centre

Wheel centre: Die-cast aluminium alloy

Fork



Finish: electro-zinc plated, double ball bearing – revited, hardened steel balls thermoplastic dust protection ring, wheel axle bolted, total lock

Fixed castor	Wheel-Ø A x width B mm: 125x50
Load Capacity kg:	170
Load capacity tested according to EN 12530 and EN 12527	
Overall height H mm:	160
Dimension of top plate TP mm:	102x83
Hole spacing HS mm:	80x60
Hole-Ø HD mm:	9
Wheel bearing:	Roller bearing

Advantages

- ✓ excellent running performance
- ✓ very silent in motion
- ✓ low rolling resistance
- ✓ good abrasion resistance
- ✓ corrosion resistant
- ✓ non-marking in grey

©Copyright 2024 Rollenbau GmbH, [www.rollenbau.at](http://www.rollenbau.at) 20.05.2024

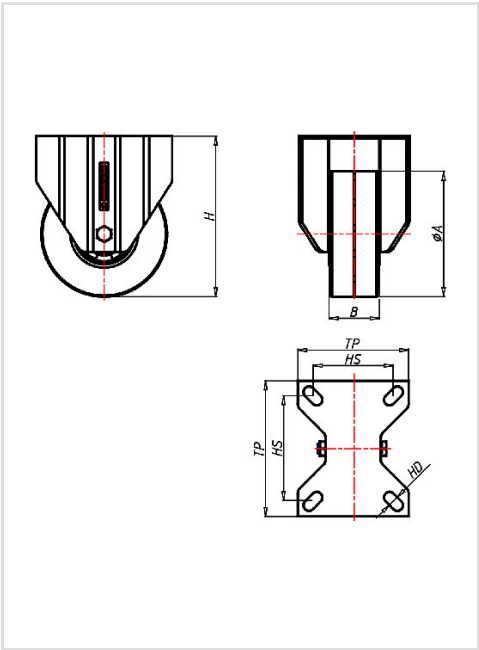

Applications

- Bins
- Refuse bins
- Dollies
- Trash containers
- Refuse containers